

# CH/HH HORIZONTAL PLATE CLAMPS

**SOLD IN PAIRS**

## Industry standard horizontal plate clamps

Working load limit (WLL) 1000 - 10000kg

The CH horizontal plate clamps have been specifically designed to be used in pairs for the transportation of plate bundles as well as single plates with a minimum thickness of 5mm.

A pair of clamps used with a two legged chain sling are suitable for small plates. It is recommended to use two pairs in conjunction with a spreader beam for handling of larger plates. These units are supplied as standard with a smooth jaw. There is also the option of hardened steel teeth jaws for special applications. Please contact our technical department for further details.

The HH horizontal plate clamps incorporate all of the features of the CH clamps, yet are manufactured from high strength steel giving them exceptionally low tare weights.

### Workmanship and parts

These plate clamps are service-friendly, making it easy to exchange parts, which are readily available. Clamp repairs are available through the factory, or can be done by a competent person.



CH with serrated jaw which can only be used for single plates, NOT bundles

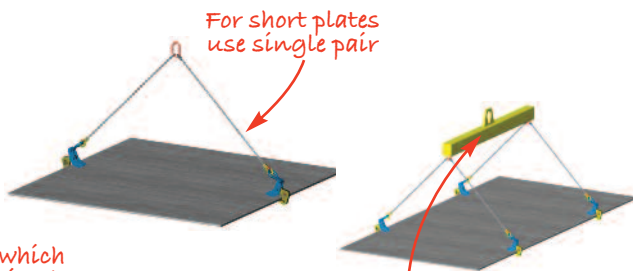

For short plates use single pair

For long plates use spreader beam



| Model  | WLL   | Jaw capacity | A  | B   | C   | D   | E   | F   | G       | Weight |
|--------|-------|--------------|----|-----|-----|-----|-----|-----|---------|--------|
|        | kg*   | mm           | mm | mm  | mm  | mm  | mm  | mm  | mm      | kg**   |
| CH1*** | 1000  | 5 - 32       | 30 | 82  | 60  | 100 | 32  | 44  | 13      | 8      |
| CH2    | 2000  | 5 - 32       | 30 | 82  | 60  | 100 | 50  | 73  | 18      | 11     |
| CH2L   | 2000  | 20 - 50      | 30 | 82  | 60  | 100 | 50  | 73  | 18      | 12     |
| CH4    | 4000  | 5 - 50       | 40 | 112 | 80  | 100 | 64  | 92  | 25      | 17     |
| CH4L   | 4000  | 50 - 100     | 40 | 112 | 80  | 100 | 64  | 92  | 25      | 23     |
| CH6    | 6000  | 5 - 75       | 55 | 172 | 100 | 130 | 90  | 130 | 35      | 46     |
| CH6L   | 6000  | 50 - 125     | 55 | 172 | 100 | 130 | 90  | 130 | 35      | 56     |
| CH8    | 8000  | 5 - 75       | 55 | 172 | 105 | 130 | 90  | 130 | 35      | 53     |
| CH8L   | 8000  | 50 - 125     | 55 | 172 | 105 | 130 | 90  | 130 | 35      | 60     |
| CH10   | 10000 | 5 - 100      | 65 | 215 | 120 | 150 | 114 | 114 | 37 x 50 | 95     |
| CH10L  | 10000 | 50 - 150     | 65 | 215 | 120 | 150 | 114 | 114 | 37 x 50 | 108    |
| CH15   | 15000 | 5 - 100      | 71 | 230 | 120 | 150 | 114 | 114 | 37 x 50 | 110    |
| CH15L  | 15000 | 50 - 150     | 71 | 230 | 120 | 150 | 114 | 114 | 37 x 50 | 123    |
| CH20   | 20000 | 5 - 100      | 70 | 220 | 118 | 220 | 80  | 120 | 38 x 60 | 165    |
| CH20L  | 20000 | 50 - 150     | 70 | 220 | 118 | 220 | 80  | 120 | 38 x 60 | 172    |
| HH8    | 8000  | 5 - 50       | 55 | 168 | 105 | 130 | 67  | 67  | 24      | 21     |
| HH8L   | 8000  | 50 - 100     | 55 | 168 | 105 | 130 | 67  | 67  | 24      | 28     |

\*Per pair.

\*\*Weight per pair of clamps without chains.

\*\*\*NB. CH1 is fitted with a single jaw.



\*Chain slings NOT included

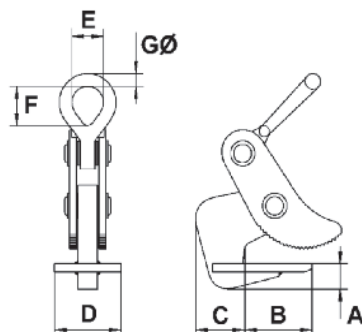

NB: The angle between the chain / rope legs must not exceed 45° from vertical

**!** NB: These units must NOT be used with endless chain slings.