

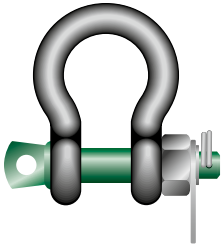

Green Pin® Catch Shackle BN

Standard bow shackle with safety bolt which enables all components to be tethered

Scan for additional product details



G-4163H

- **Material:** bow and pin high tensile steel, grade 6, quenched and tempered
- **Safety Factor:** MBL equals 6 x WLL
- **Standard:** ISO 2415, EN 13889 and meets performance requirements of US Fed. Spec. RR-C-271, Type IVA, Class 3, Grade A and comply with ASME B30.26
- **Finish:** hot dipped galvanized
- **Temperature Range:** -40 °C up to +200 °C
- **Certification:** 2.1 2.2 3.1 MTC³ DNV 2.7-1^a DNV 2.7-1^b CE IIA ABS PDA ABS MA
- **Article code:** scan QR code to see article codes
- **Note:** supplied without wires

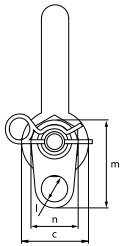
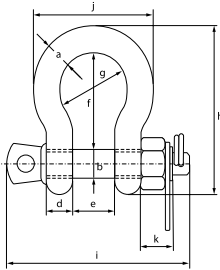

working load limit	diameter bow	diameter pin	diameter eye	width eye	width inside	length inside	width bow	length bow	length bolt	width bolt	thickness nut	diameter hole	height	width	weight each
t	a	b	c	d	e	f	g	h	i	j	k	l	m	n	kg
2	13.5	16	34	13	22	51	32	89	102	58	19	15	48.4	27	0.47
3.25	16	19	40	16	27	64	43	110	122	75	23	15	53.7	31.8	0.81
4.75	19	22	46	19	31	76	51	129	143	89	26	15	60.1	36.5	1.32
6.5	22	25	52	22	36	83	58	144	160.5	102	29	15	65.5	41.3	1.92
8.5	25	28	59	25	43	95	68	164	183	118	32	15	70.5	46	2.77
9.5	28	32	66	28	47	108	75	185	201	131	34	15	74	50.8	3.91

CAD INFO

