



# Green Pin® Dee Shackle SC

## Standard dee shackle with screw collar pin

Scan for additional product details



- **Material:** bow and pin high tensile steel, grade 6, quenched and tempered
- **Safety Factor:** MBL equals 6 x WLL
- **Standard:** ISO 2415, EN 13889 and meets performance requirements of US Fed. Spec. RR-C-271 Type IVB Class 2, grade A, from 2 t upward these shackles comply with ASME B30.26
- **Finish:** hot dipped galvanized
- **Temperature Range:** -40 °C up to +200 °C
- **Certification:** 2.1 2.2 3.1 MTC<sup>a</sup> DNV 0378 CE IIA ABS PDA ABS MA
- **Article code:** scan QR code to see article codes

G-4151

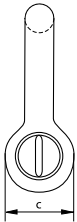
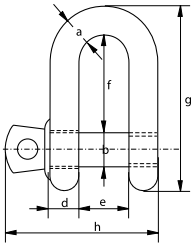

working load limit	diameter bow	diameter pin	diameter eye	width eye	width inside	length inside	length	length bolt	weight each
t	a mm	b mm	c mm	d mm	e mm	f mm	g mm	h mm	kg
0.33	5	6	12	5	9.5	19	33	29.5	0.02
0.5	7	8	16	7	12	22.5	41.5	38	0.05
0.75	9	10	20	9	13.5	27	51	46.5	0.09
1	10	11	23	10	17	32	59	54	0.14
1.5	11	13	25	11	19	37	67	59.5	0.19
2	13.5	16	34	13	22	43	82	73	0.32
3.25	16	19	40	16	27	51	97	89	0.54
4.75	19	22	46	19	31	59	112	103	0.87
6.5	22	25	52	22	36	73	134	119	1.34
8.5	25	28	59	25	43	85	154	137	2.08
9.5	28	32	67	28	47	90	168	153	2.77
12	32	35	73	32	51	94	180	170	3.72
13.5	35	38	79	35	57	115	209	186	5.44
17	38	42	88	38	60	127	230	203	6.85
25	45	50	104	45	74	149	271	243	11.5
35	50	57	112	50	83	171	306	272	16.9
42.5	57	65	132	57	95	190	346	310	24.6
55	65	70	145	65	105	203	376	344	32.7

CAD RFID INFO

