

G-210

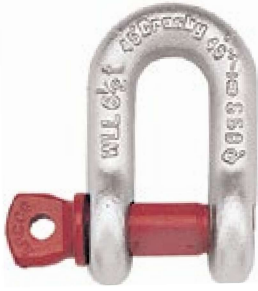

- Forged, Quenched & Tempered, with alloy pins.
- Working Load Limit and Grade 6 permanently shown on every shackle.
- Hot-dip galvanized.
- Sizes 3/8 inch and below are mechanically galvanized.
- Fatigue rated at 1-1/2 times the Working Load Limit at 20,000 cycles.
- Shackles can be furnished proof tested with certificates to designated standards, such as ABS, DNV, Lloyds, or other certifications. Proof testing and certification available when requested at the time of order, charges will apply.
- Approved for use at -40° C (-40° F) to 204° C (400° F).
- All 210 shackles can meet charpy requirements of 42 Joules (31 ft-lb) avg. at -20° C (-4° F) upon special request.
- Meets or exceeds all requirements of ASME B30.26.
- Type Approval certification in accordance with ABS Marine Vessel Rules, ABS Mobile Offshore Units, and ABS Guide for the Certification of Lifting Appliances available. Certificates available when requested at time of order and may include additional charges.
- G-210 Screw pin anchor shackles meet the performance requirements of Federal Specification RR-C-271, Type IVB, Grade A, Class 2, except for those provisions required of the contractor.
- Look for the Red Pin®... the mark of genuine Crosby quality.

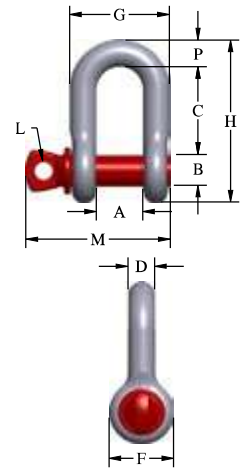

G-210 Screw Pin Chain Shackles

Nominal Size (in)	Working Load Limit (t)	Stock No.	Weight Each (kg)	Dimensions (mm)													Replacement Pin Stock No.
				A	Tol. A ±	B	C	Tol. C ±	D	F	G	H	L	M	P		
1/4	1/2	1019150	.05	12	1.5	8	22	1.5	6	16	25	40	5	36	6	-	
5/16	3/4	1019178	.08	14	1.5	10	26	1.5	8	19	29	48	6	43	8	-	
3/8	1	1019196	.13	17	1.5	11	32	3.3	10	23	36	59	6	52	10	-	
7/16	1 1/2	1019212	.20	19	1.5	13	37	3.3	11	27	41	68	8	60	11	-	
1/2	2	1019230	.29	21	1.5	16	41	3.3	13	30	46	77	10	68	13	-	
5/8	3 1/4	1019258	.57	27	1.5	19	51	3.3	16	38	59	96	11	85	16	-	
3/4	4 3/4	1019276	1.03	32	1.5	22	60	6.4	19	46	70	115	13	101	21	-	
7/8	6 1/2	1019294	1.43	37	1.5	25	71	6.4	22	53	81	135	13	114	25	-	
1	8 1/2	1019310	2.15	43	1.5	29	81	6.4	25	60	94	151	14	130	25	-	
1-1/8	9 1/2	1019338	3.06	46	1.5	32	90	6.4	29	68	103	172	16	152	32	1082599	
1-1/4	12	1019356	4.11	52	3.3	36	100	6.4	32	76	115	191	18	165	35	1082615	
1-3/8	13 1/2	1019374	5.28	57	3.3	40	111	6.4	35	84	127	210	19	176	38	1082633	
1-1/2	17	1019392	7.23	60	3.3	42	124	6.4	38	92	137	230	21	189	41	1082651	
1-3/4	25	1019418	12.1	73	3.3	52	146	6.4	44	106	162	279	25	233	54	1082679	
2	35	1019436	19.2	83	3.3	58	171	6.4	53	127	184	324	29	263	60	1082697	
2-1/2	55	1019454	32.5	105	6.4	71	203	6.4	67	144	238	377	35	335	67	1082713	

6:1 Design Factor. Maximum Proof Load is 2 times the Working Load Limit. For Working Load Limit reduction due to side loading applications, see Warnings & Applications.

