

HA Universal Swivel Point (Metric)

HA Universal Swivel Point (Metric)

The HA universal swivel point (metric) is a bolt-on load attachment product designed for use with loads that incorporate tapped holes. It is fitted with internal ball bearings, enabling smooth rotation 360° around the bolt axis, even whilst under load. It also features an independent connecting link which can pivot 230°. This allows the lifting point to orientate to the appropriate angle of lift, mitigating the risk of damage. The HA universal swivel point (metric) is suitable for both top and side mounting, and maintains its full working load limit even when pulled at 90°.

Standards: designed and manufactured in accordance with EN1677-1 and ASME B30.26.

Product sizes: available in sizes M8 to M64 and with working load limits from 0.4 tonnes to 20.0 tonnes.

Product markings: body marked with manufacture mark "HA", batch number for product material traceability, thread size, and working load limit (based on 4 : 1 safety factor). Connecting link marked with batch code for product material traceability.

Temperature: operational temperature range of - 40°C to + 200°C without reduction in working load limit, and fatigue rated to 20,000 cycles at 1.5 times working load limit.

Material: alloy steel.

Bolt Grade: 10.9.

Testing: load rated parts are subject to 100% magnaflux crack detection following heat treatment. HA universal swivel points are proof tested to 2.5 times working load limit.

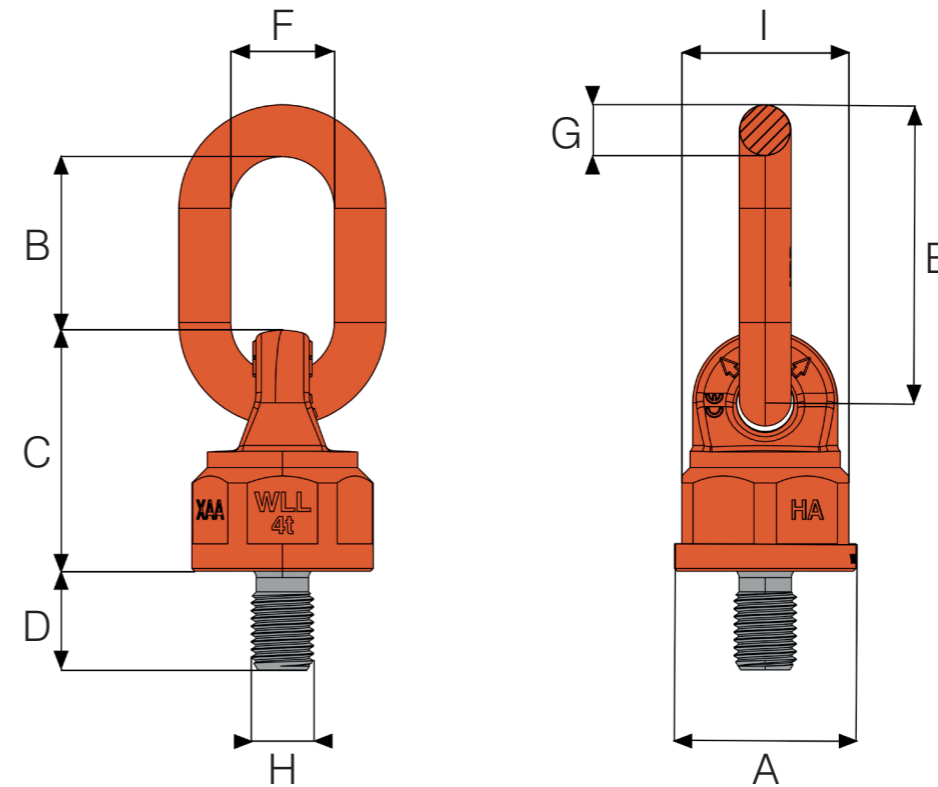

Specifications

PART CODE	WLL t	THREAD M	A mm	B mm	C mm	D mm	E mm	F mm	G mm	H mm	I mm	TORQUE Nm	MASS kg
8-H21-M08	0.4	M8	40.0	43.5	54.0	12.0	70.5	30.0	12.0	8.0	37.0	15	0.44
8-H21-M10	0.6	M10	40.0	43.5	54.0	19.0	70.5	30.0	12.0	10.0	37.0	15	0.45
8-H21-M12	0.7	M12	40.0	43.5	54.0	19.0	70.5	30.0	12.0	12.0	37.0	20	0.45
8-H21-M16	1.5	M16	40.0	43.5	54.0	31.8	70.5	30.0	12.0	16.0	37.0	55	0.45
8-H21-M20	2.5	M20	70.0	67.0	93.0	38.1	114.0	40.0	20.0	20.0	64.5	120	2.30
8-H21-M24	4.0	M24	70.0	67.0	93.0	38.1	114.0	40.0	20.0	24.0	64.5	200	2.35
8-H21-M30	6.0	M30	79.0	95.0	111.0	50.0	148.0	51.0	22.0	30.0	74.0	350	3.75
8-H21-M36	10.0	M36	79.0	95.0	111.0	54.0	148.0	51.0	22.0	36.0	74.0	410	3.90
8-H21-M42	13.0	M42	93.0	108.0	122.5	63.0	169.0	65.0	26.0	42.0	85.0	550	5.90
8-H21-M48	14.0	M48	93.0	108.0	122.5	68.0	169.0	65.0	26.0	48.0	85.0	550	6.15
8-H21-M56	20.0	M56	105.0	120.0	158.0	84.0	194.0	70.0	32.0	56.0	95.0	700	10.00
8-H21-M64	20.0	M64	105.0	120.0	158.0	95.0	194.0	70.0	32.0	64.0	95.0	800	10.70

mharwood@rhtltd.co.uk

www.rhtltd.co.uk

+44 (0)1953 889998



HA Universal Swivel Point (Metric)

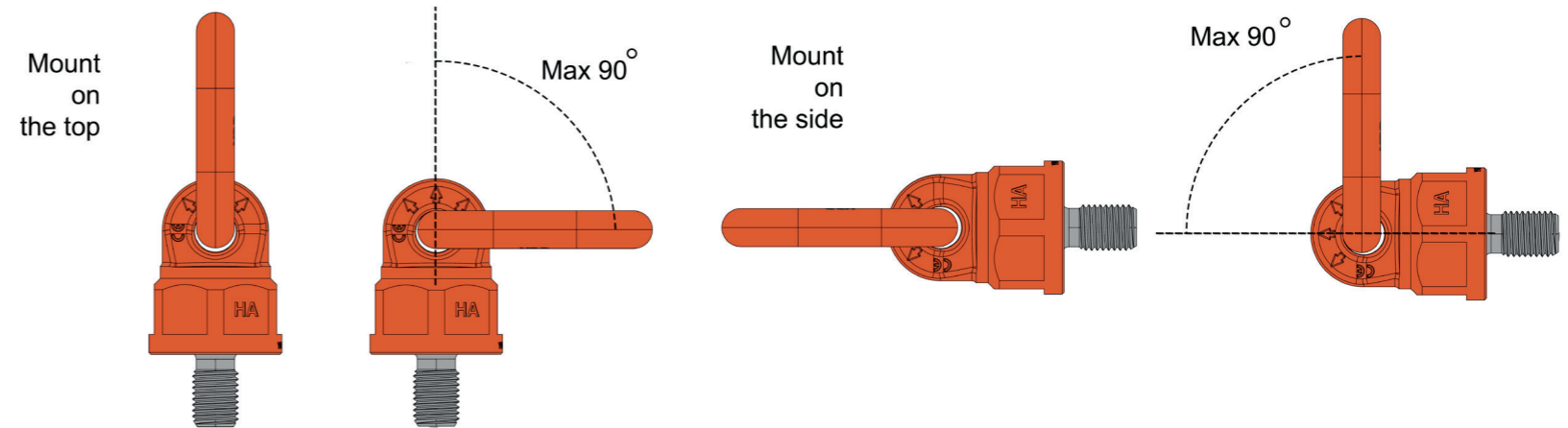

NUMBER OF LEGS	1		2		2		3-4			
	0°	90°	0°	90°	0-45°	45-60°	unsym	0-45°	45-60°	unsym
Load Direction	0°	90°	0°	90°	0-45°	45-60°	unsym	0-45°	45-60°	unsym

PART CODE	THREAD	WLL (in tonnes) BY LIFTING APPLICATION									
		0°	90°	0°	90°	0-45°	45-60°	unsym	0-45°	45-60°	unsym
8-H21-M08	M8	0.4	0.8	0.4	0.8	0.56	0.4	0.4	0.84	0.60	0.4
8-H21-M10	M10	0.6	1.2	0.6	1.2	0.84	0.6	0.6	1.25	0.90	0.6
8-H21-M12	M12	0.7	1.4	0.7	1.4	0.98	0.7	0.7	1.47	1.05	0.7
8-H21-M16	M16	1.5	3.0	1.5	3.0	2.10	1.5	1.5	3.15	2.25	1.5
8-H21-M20	M20	2.5	5.0	2.5	5.0	3.50	2.5	2.5	5.25	3.75	2.5
8-H21-M24	M24	4.0	8.0	4.0	8.0	5.60	4.0	4.0	8.40	6.00	4.0
8-H21-M30	M30	6.0	12.0	6.0	12.0	8.40	6.0	6.0	12.60	9.00	6.0
8-H21-M36	M36	10.0	20.0	10.0	20.0	14.00	10.0	10.0	21.00	15.00	10.0
8-H21-M42	M42	13.0	26.0	13.0	26.0	18.20	13.0	13.0	27.30	19.50	13.0
8-H21-M48	M48	14.0	28.0	14.0	28.0	19.60	14.0	14.0	29.40	21.00	14.0
8-H21-M56	M56	20.0	40.0	20.0	40.0	28.00	20.0	20.0	42.00	30.00	20.0
8-H21-M64	M64	20.0	40.0	20.0	40.0	28.00	20.0	20.0	42.00	30.00	20.0

mharwood@rhtltd.co.uk

www.rhtltd.co.uk

+44 (0)1953 889998

