

HA Swivel Hoist Ring (UNC)

HA Swivel Hoist Ring (UNC)

The HA swivel hoist ring (UNC) is a bolt-on load attachment product designed for use with loads that incorporate tapped holes. It can rotate 360° around the bolt axis, as well as pivot 180°, allowing the hoist ring to orientate to the appropriate angle of lift, mitigating the risk of damage. The HA swivel hoist ring (UNC) is suitable for both top and side mounting, and maintains its full working load limit even when pulled at 90°.

Standards: designed and manufactured in accordance with EN1677-1 and ASME B30.26.

Product sizes: available in sizes 1/2" to 2-1/2" and with working load limits from 2200 lbs to 49500 lbs.

Product markings: forged bail marked with manufacturer name "Hackett" and batch number for product material traceability. Body marked with recommended torque rating and working load limits in lbs (based on 4 : 1 and 5 : 1 safety factors). Bolt marked with UNC size, material grade, "HA" branding, and batch number for bolt material traceability.

Temperature: operational temperature range of -40°C to + 200°C without reduction in working load limit.

Material: alloy steel.

Bolt Grade: 10.9.

Testing: load rated parts are subject to 100% magnaflux crack detection following heat treatment. HA swivel hoist rings are proof tested to 2.5 times working load limit, and fatigue rated to 20,000 cycles at 1.5 times working load limit.

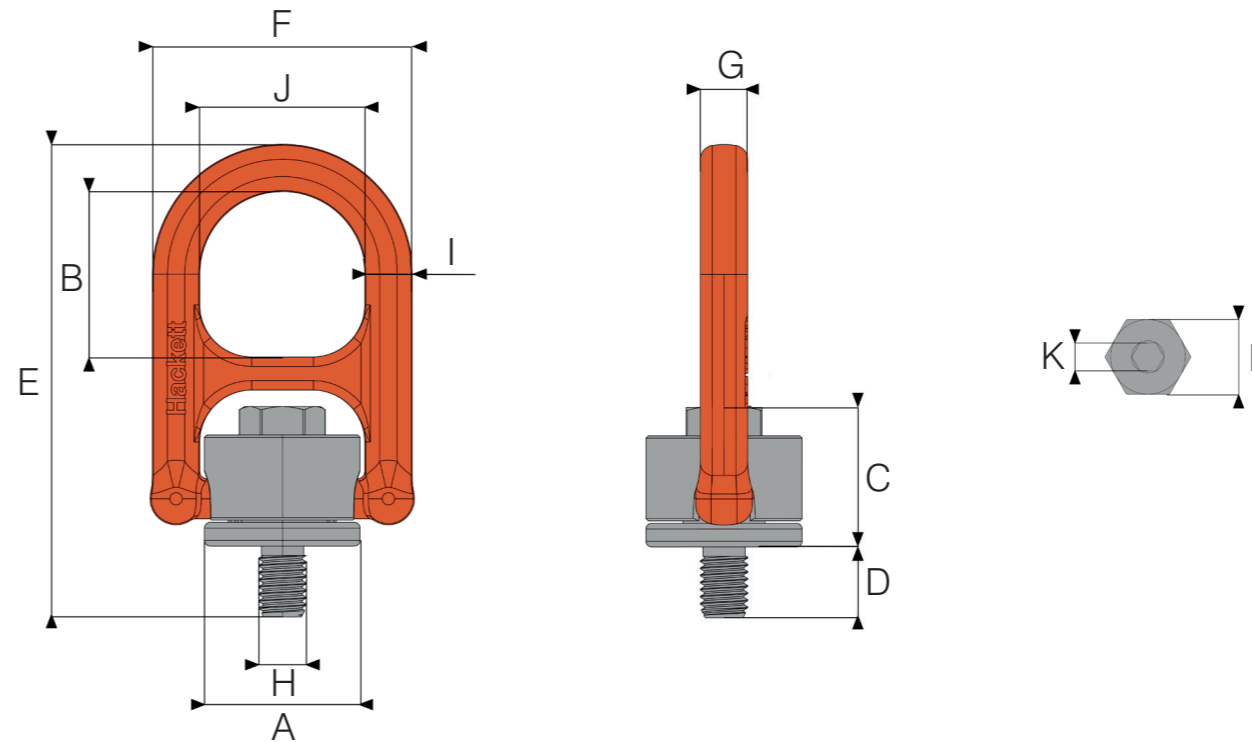

Specifications

PART CODE	WLL lbs	THREAD inch	A inch	B inch	C inch	D inch	E inch	F inch	G inch	H inch	I inch	J inch	K inch	L inch	TORQUE Nm	MASS lbs
8-H20-UNC12G	2200	1/2-13UNC-2A	1.97	2.17	1.85	0.79	5.94	3.23	0.51	0.50	0.55	2.13	0.39	0.94	100	2.20
8-H20-UNC16G	4400	5/8-11UNC-2A	1.97	2.17	1.85	0.94	6.10	3.23	0.51	0.62	0.55	2.13	0.39	0.94	150	2.20
8-H20-UNC20G	6600	3/4-10UNC-2A	2.56	2.60	2.30	1.18	7.60	4.13	0.63	0.75	0.71	2.72	0.47	1.18	250	4.41
8-H20-UNC22G	8250	7/8-9UNC-2A	2.56	2.60	2.30	1.42	7.83	4.13	0.63	0.88	0.71	2.72	0.55	1.42	300	4.63
8-H20-UNC26G	11000	1-8UNC-2A	2.56	2.60	2.30	1.42	7.83	4.13	0.63	1.00	0.71	2.72	0.55	1.42	420	4.63
8-H20-UNC32G	17200	1-1/4-7UNC-2A	3.43	3.15	3.25	1.89	10.49	5.71	0.98	1.25	1.06	3.58	0.67	1.81	500	13.23
8-H20-UNC36G	27500	1-1/2-6UNC-2A	4.33	3.94	3.70	2.44	12.48	7.32	1.30	1.50	1.42	3.46	0.75	2.76	800	26.46
8-H20-UNC48G	44000	2-4.5UNC-2A	4.33	3.94	3.86	2.99	13.03	7.32	1.30	2.00	1.89	3.46	0.75	2.76	800	27.34
8-H20-UNC56G	48400	2-1/4-4.5UNC-2A	4.84	4.33	4.33	3.31	14.29	7.83	1.38	2.25	2.20	3.82	0.75	3.15	800	36.38
8-H20-UNC64G	49500	2-1/2-4UNC-2A	4.84	4.33	4.33	3.74	14.72	7.83	1.38	2.50	2.52	3.82	0.75	3.15	800	37.48

mharwood@rhtltd.co.uk

www.rhtltd.co.uk

+44 (0)1953 889998



HA Swivel Hoist Ring (UNC)

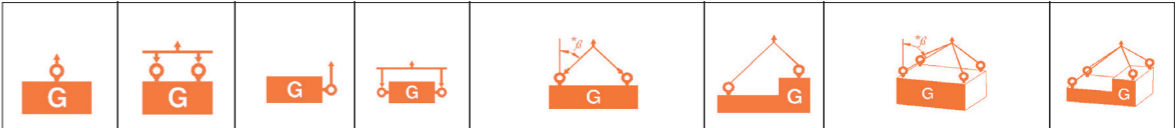
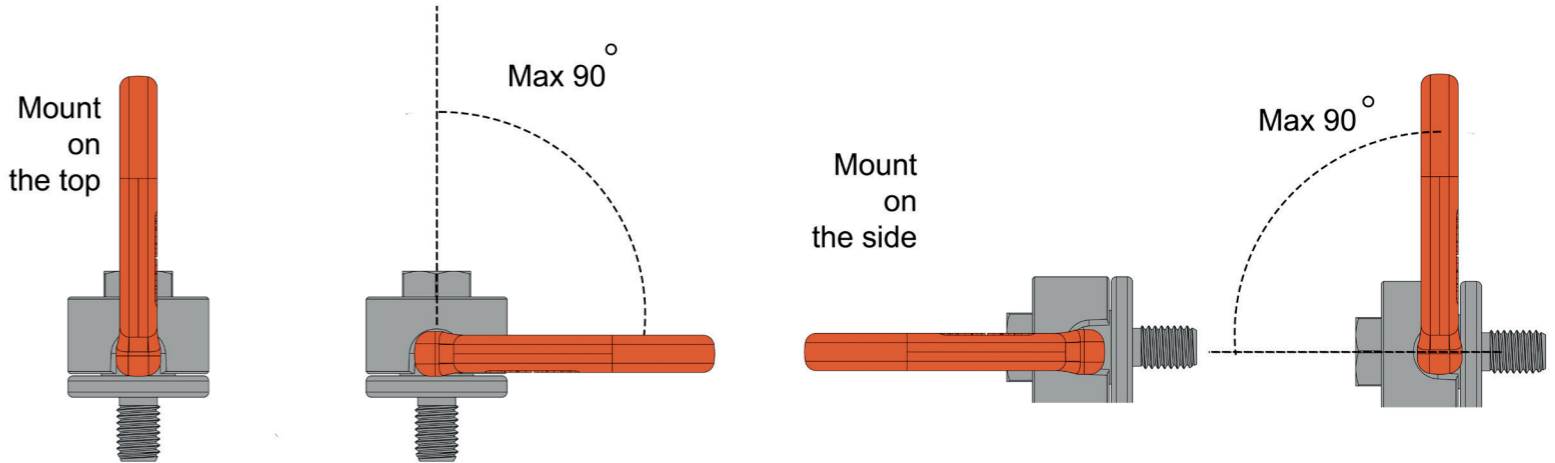

NUMBER OF LEGS	1	2	1	2	2	2	2	3-4	3-4	
Load Direction	0°	0°	90°	90°	0-45°	45-60°	unsym	0-45°	45-60°	unsym

PART CODE	THREAD	WLL (in lbs) BY LIFTING APPLICATION									
		1 leg 0°	2 legs 0°	1 leg 90°	2 legs 90°	2 legs 0-45°	2 legs 45-60°	2 legs unsym	3-4 legs 0-45°	3-4 legs 45-60°	3-4 legs unsym
8-H20-UNC12G	1/2-13UNC-2A	2200	4400	2200	4400	3080	2200	2200	4620	3300	2200
8-H20-UNC16G	5/8-11UNC-2A	4400	8800	4400	8800	6160	4400	4400	9240	6600	4400
8-H20-UNC20G	3/4-10UNC-2A	6600	13200	6600	13200	9240	6600	6600	13860	9900	6600
8-H20-UNC22G	7/8-9UNC-2A	8250	16500	8250	16500	11550	8250	8250	17325	12575	8250
8-H20-UNC26G	1-8UNC-2A	11000	22000	11000	22000	15400	11000	11000	23100	16500	11000
8-H20-UNC32G	1-1/4-7UNC-2A	17200	34400	17200	34400	24080	17200	17200	36120	25800	17200
8-H20-UNC36G	1-1/2-6UNC-2A	27500	55000	27500	55000	38500	27500	27500	57750	41250	27500
8-H20-UNC48G	2-4.5UNC-2A	44000	88000	44000	88000	61600	44000	44000	92400	66000	44000
8-H20-UNC56G	2-1/4-4.5UNC-2A	48400	96800	48400	96800	67760	48400	48400	101640	72600	48400
8-H20-UNC64G	2-1/2-4UNC-2A	49500	99000	49500	99000	69300	49500	49500	103950	74250	49500