



Hack10 Clevis Skip Hook

Hack10 Clevis Skip Hook

The Hack10 clevis skip hook is specifically designed for lifting waste skips and recycling bins as part of a Hackett chain sling assembly. The skip hook features a spring loaded gate that click fastens securely to a skip's trunnions. Manufactured from alloy steel, the Hack10 clevis skip hook is 25% stronger than a grade 8 equivalent, delivering a greater working load limit without the need for a larger diameter chain sling.

Standards: designed and manufactured in accordance with EN1677-1, ASTM A952/A952M, and DIN PAS 1061 and suitable for use in chain slings certified to EN818-4.

Product sizes: available for chain size 13mm and with a working load limit of 6.7 tonnes

Temperature: operational temperature range of - 40°C to + 200°C without reduction in working load limit.

Material: alloy steel.

Testing: crack detection following heat treatment, and proof load tested to 2.5 times working load limit.

Safety factor: 4 : 1.

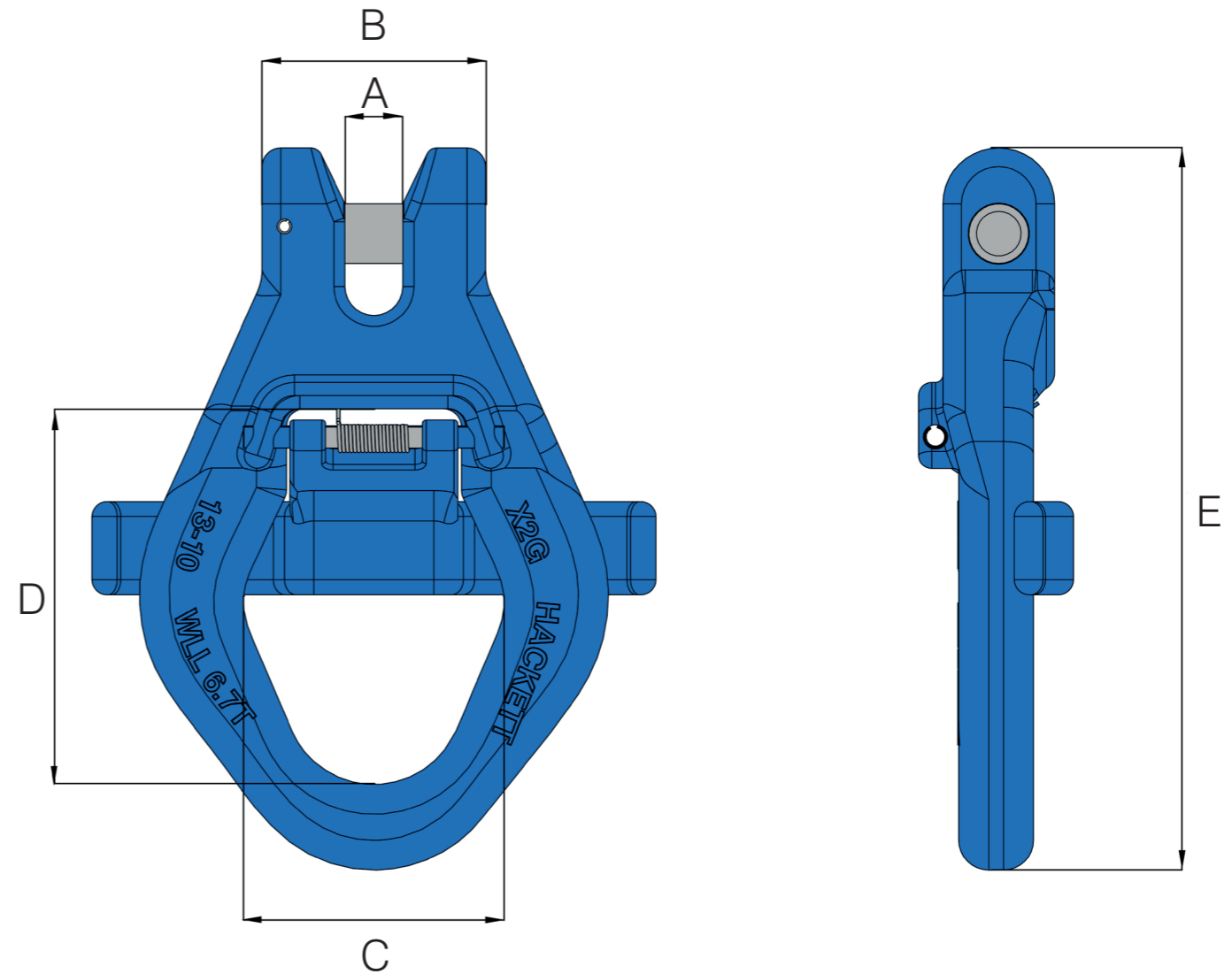

Metric Specifications

PART CODE	CHAIN SIZE mm	A mm	B mm	C mm	D mm	E mm	BOX QTY.	WLL tonnes	MASS kg
10-H16-13	13	15.5	60.0	71.5	104.0	195.0	8	5.3	1.9

enquiries@rhtltd.co.uk

www.rhtltd.co.uk

+44 (0) 1953 889998





Hack10 Clevis Skip Hook

Hack10 Clevis Skip Hook

The Hack10 clevis skip hook is specifically designed for lifting waste skips and recycling bins as part of a Hackett chain sling assembly. The skip hook features a spring loaded gate that click fastens securely to a skip's trunnions. Manufactured from alloy steel, the Hack10 clevis skip hook is 25% stronger than a grade 8 equivalent, delivering a greater working load limit without the need for a larger diameter chain sling.

Standards: designed and manufactured in accordance with EN1677-1, ASTM A952/A952M, and DIN PAS 1061 and suitable for use in chain slings certified to EN818-4.

Product sizes: available for chain size 1/2 inch and with a working load limit of 15,000 lbs.

Temperature: operational temperature range of - 40°C to + 200°C without reduction in working load limit.

Material: alloy steel.

Testing: crack detection following heat treatment, and proof load tested to 2.5 times working load limit.

Safety factor: 4 : 1.

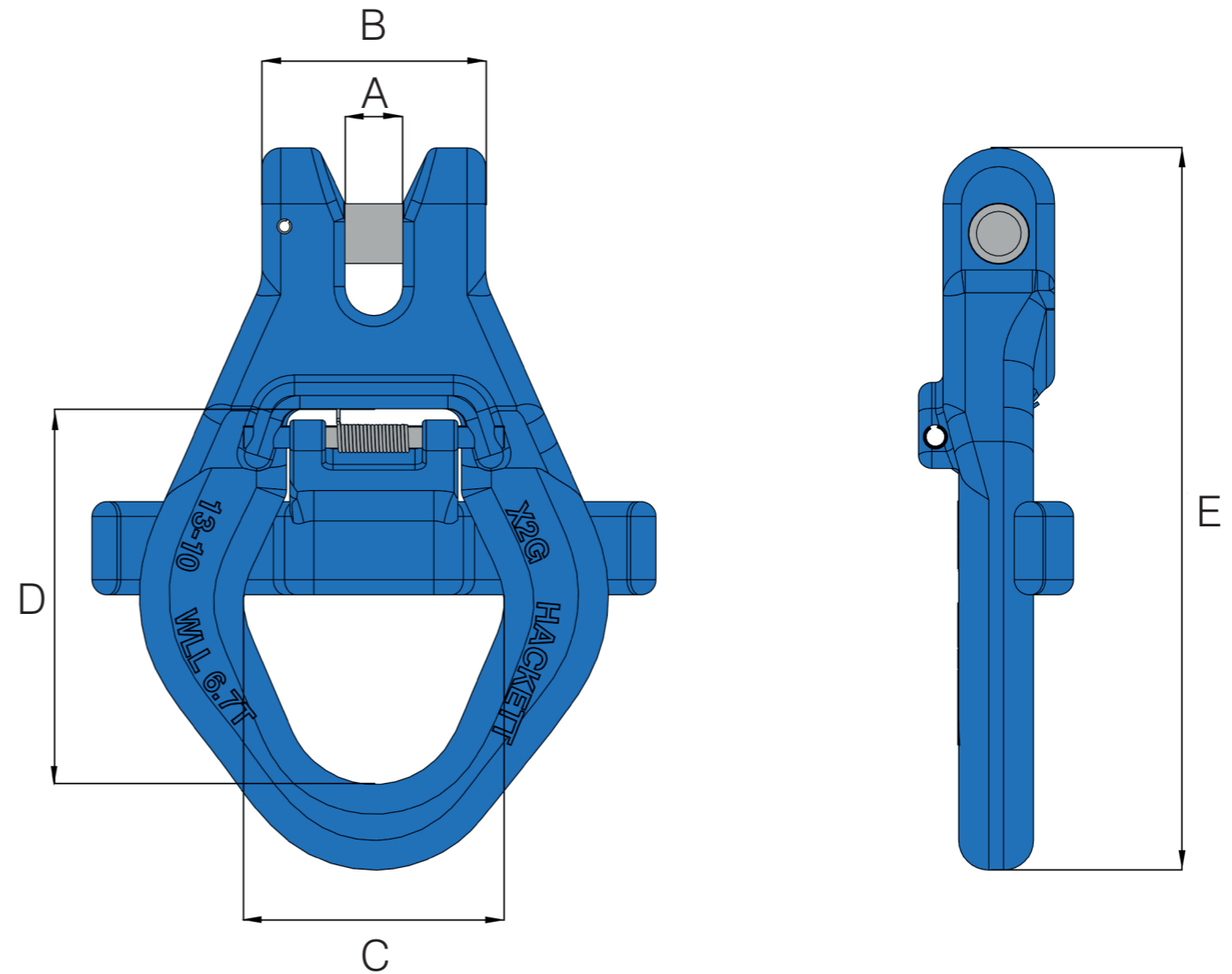

Imperial Specifications

PART CODE	CHAIN SIZE inch	A inch	B inch	C inch	D inch	E inch	BOX QTY.	WLL lbs	MASS lbs
10-H16-13	1/2	0.61	2.36	2.81	4.09	7.68	8	15000	4.19

enquiries@rhtltd.co.uk

www.rhtltd.co.uk

+44 (0) 1953 889998

