

HA Weld-on Lifting Point

The HA weld-on lifting point is a load attachment product that is used as a fixed anchor in lifting, towing and lashing applications. As its name suggests, it is specifically designed to be permanently attached by welding to a structure, surface or load. It features a large D-ring with a generous aperture for easy connection with a wide range of lifting and lashing equipment, such as chain sling components and polyester straps. It also features an internal spring which allows the D-ring to remain upright whilst free from load. Manufactured from alloy steel, the HA weld-on lifting point delivers an excellent balance between toughness and ductility.

Standards: designed and manufactured in accordance with ASME B30.26.

Product sizes: available with working load limits from 1.12 tonnes to 20.0 tonnes.

Temperature: operational temperature range of - 40°C to + 200°C without reduction in working load limit.

Material: D-ring made of alloy steel. Welding block made of St 52-3 (1.0570).

Testing: load rated parts are subject to 100% magnaflux crack detection following heat treatment. HA weld-on lifting points are proof tested to 2.5 times working load limit, and fatigue rated to 1.5 times working load limit.

Safety factor: 4 : 1.

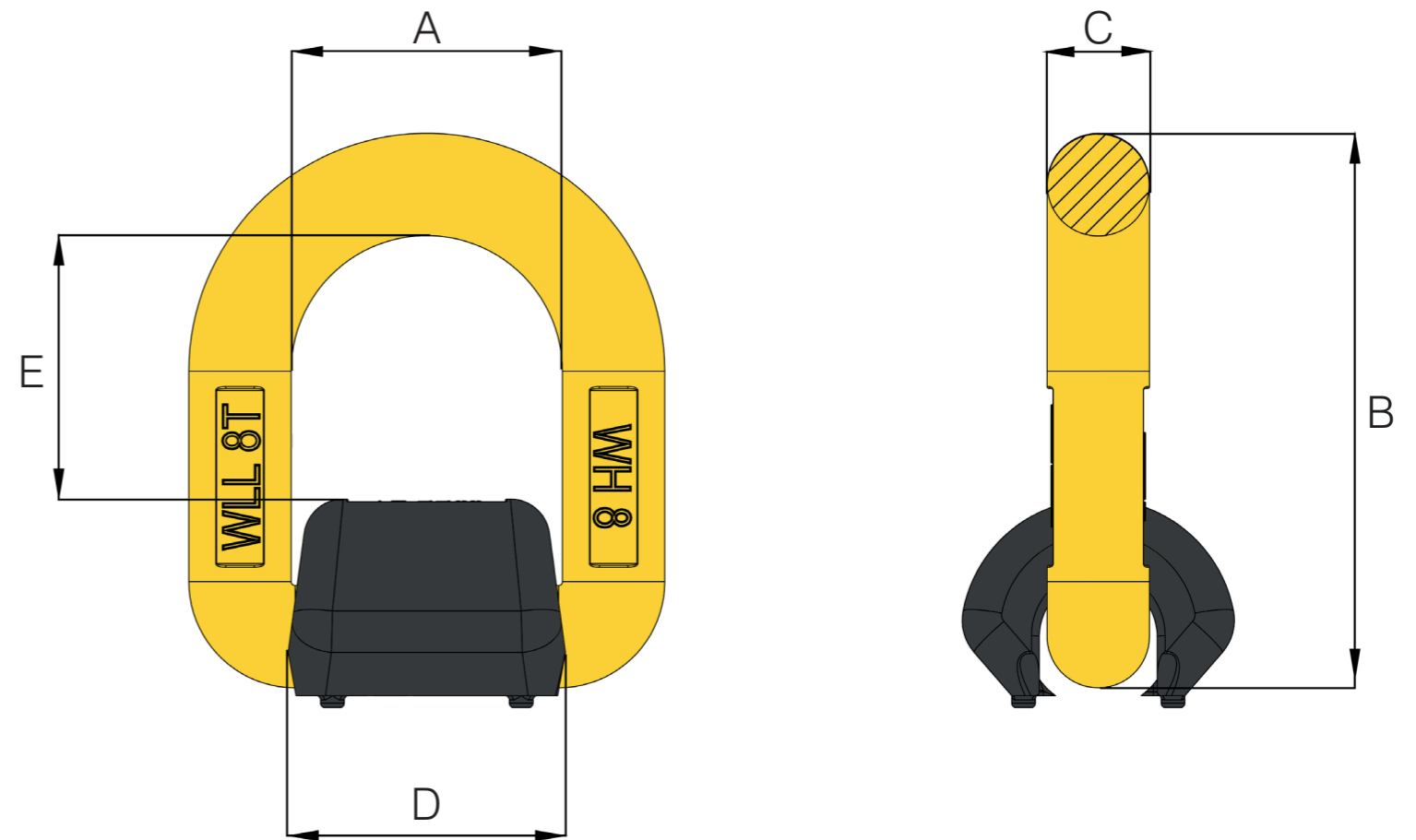

Specifications

Part Code	WLL tonnes	A mm	B mm	C mm	D mm	E mm	Box Qty.	Mass Kg
8-H08-001	1.12	41.0	78.5	13.0	37.0	34.5	50	0.40
8-H08-003	3.15	45.0	94.0	17.0	43.0	41.0	30	0.69
8-H08-005	5.30	55.0	118.0	22.0	50.0	48.0	15	1.46
8-H08-008	8.00	70.0	141.0	26.5	66.5	61.5	10	2.52
8-H08-010	10.00	85.0	165.0	28.0	78.0	77.0	6	3.59
8-H08-020	20.00	97.0	188.0	34.0	90.0	86.0	4	5.79

HA Weld-on Lifting Point

The HA weld-on lifting point is a load attachment product that is used as a fixed anchor in lifting, towing and lashing applications. As its name suggests, it is specifically designed to be permanently attached by welding to a structure, surface or load. It features a large D-ring with a generous aperture for easy connection with a wide range of lifting and lashing equipment, such as chain sling components and polyester straps. It also features an internal spring which allows the D-ring to remain upright whilst free from load. Manufactured from alloy steel, the HA weld-on lifting point delivers an excellent balance between toughness and ductility.

Standards: designed and manufactured in accordance with ASME B30.26.

Product sizes: available with working load limits from 2,469 lbs to 34,200 lbs.

Temperature: operational temperature range of -40°F to +392°F (-40°C to +200°C) without reduction in working load limit.

Material: D-ring made of alloy steel. Welding block made of St 52-3 (1.0570).

Testing: load rated parts are subject to 100% magnaflux crack detection following heat treatment. HA weld-on lifting points are proof tested to 2.5 times working load limit, and fatigue rated to 1.5 times working load limit.

Safety factor: 4 : 1.

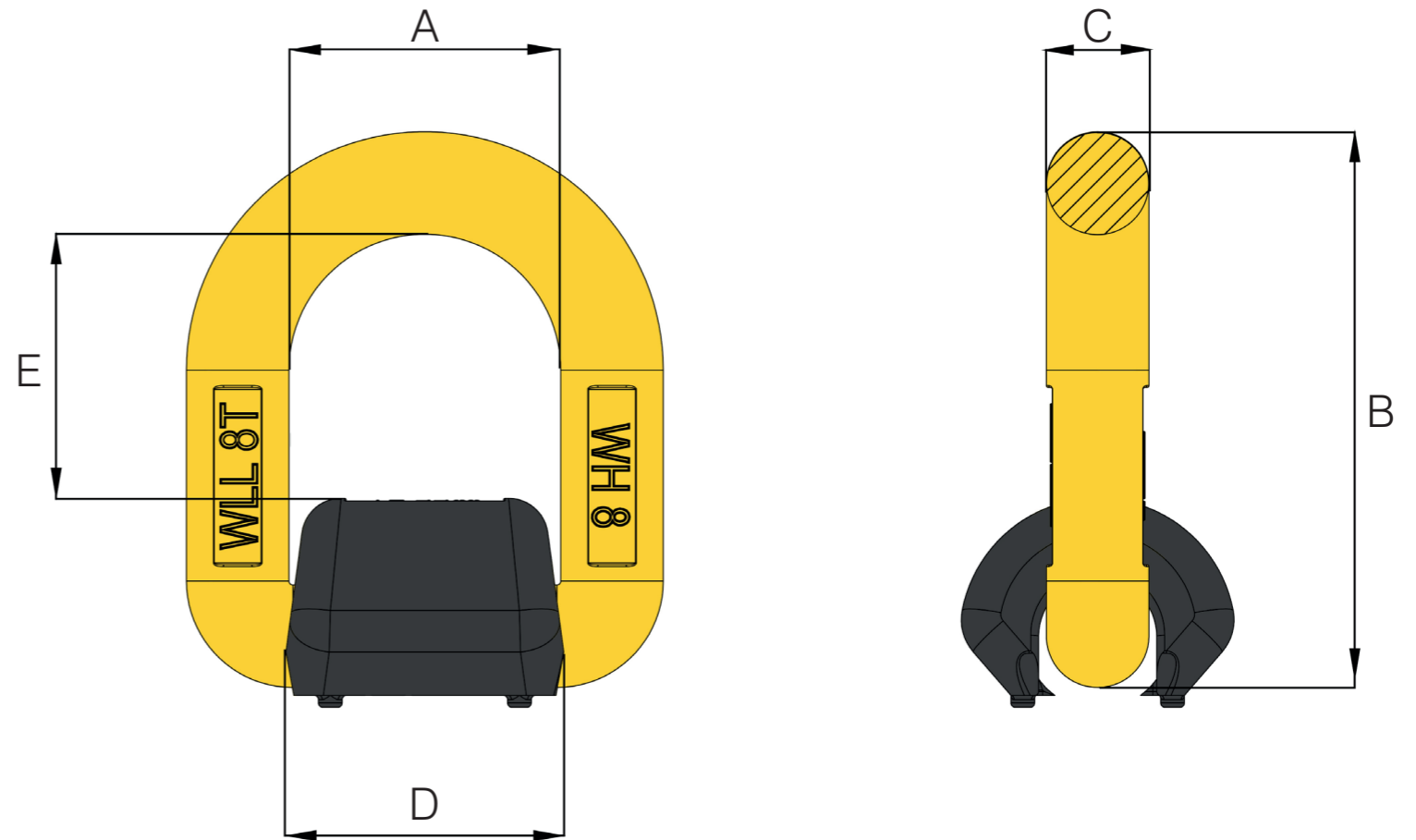

Specifications

Part Code	WLL lbs	A inch	B inch	C inch	D inch	E inch	Box Qty.	Mass lbs
8-H08-001	2469	1.61	3.09	0.51	1.45	1.36	50	0.88
8-H08-003	7100	1.77	3.70	0.66	1.69	1.61	30	1.52
8-H08-005	12000	2.16	4.64	0.86	2.40	1.89	15	3.22
8-H08-008	18100	2.75	5.55	1.04	2.62	2.42	10	5.56
8-H08-010	28300	3.35	6.50	1.10	3.07	3.03	6	7.91
8-H08-020	34200	3.82	7.40	1.34	3.54	3.39	4	12.76